

HF

HECTOR FINCH LIGHTING

HECTOR SWING ARM WALL LIGHT, RECTANGULAR BACKPLATE

Inspired by a 19th Century gas bracket, the Swing Arm Wall Light is an adjustable task light providing an ideal fitting for bedroom, study, library or drawing room. It is handmade in the UK exclusively for Hector Finch Lighting.



PRODUCT CODE WLI88

CATEGORY: WALL LIGHTS

DIMENSIONS

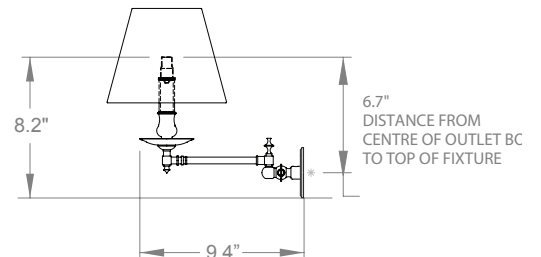
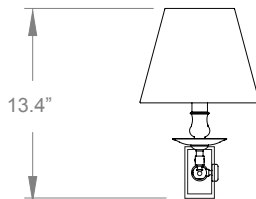
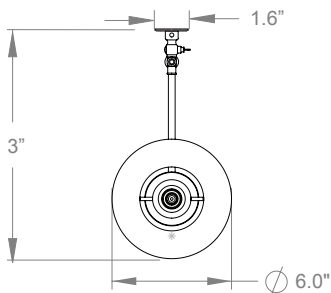

HECTOR SWING ARM WALL LIGHT, RECTANGULAR BACKPLATE

LAMP TYPE
INCANDESCENT

1 x 60w (Max) E26 General Service

APPLICATION

Not suitable for external use or bathrooms.

FINISH OPTIONS

Antique Brass (shown), Polished Unlacquered Brass, Polished Lacquered Brass, Bronze, Chrome, Nickel Brushed, Nickel Polished, Silver Plate.

SHADE OPTIONS

Round ES (6" base x 4" top x 5.5" height)